

EL10 L0.65M 2KSG 10 (410 906)

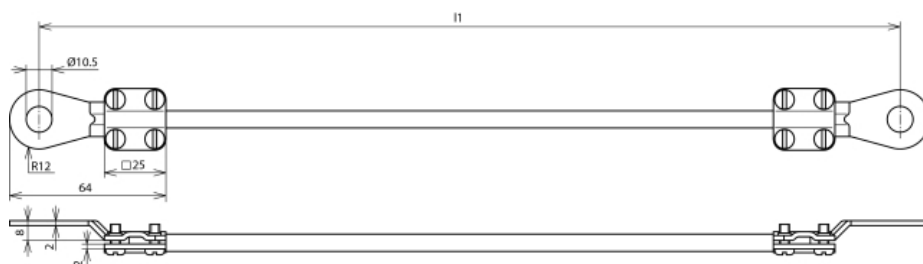

Figure without obligation

Type	EL10 L0.65M 2KSG 10
Part No.	410 906
Cable cross section	10 mm ²
Cable length (l1)	0.65 m
Cable lug closed	2x M10
Hole Ø	10.5 mm
Conductor	Cu highly flexible
Operating voltage resistance (AC / DC)	600 V
Temperature range	-40 °C ... +150 °C
Colour	black •
Cable lug material	Cu/gal Sn
Screw	⬆ M4 x 10 mm
Material of screw	St/gal Zn
Weight	140 g
Customs tariff number (Comb. Nomenclature EU)	85389099
Stock No.	6150-12-198-6810
GTIN	4013364029057
PU	1 pc(s)

We reserve the right to introduce changes in performance, configuration and technology, dimensions, weights and materials in the course of technical progress. The figures are shown without obligation.

Packing in accordance with specifications of the VG standards (defence equipment standards) must be explicitly indicated when ordering.