

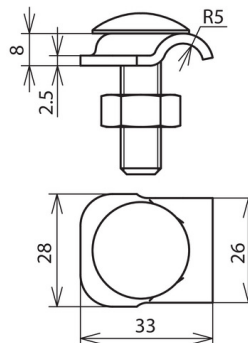

KB 6.10 FRM10X35 CU (390 157)



Figure without obligation



Arrangement:

Type	KB 6.10 FRM10X35 CU
Part No.	390 157
Material of clamp	Cu
Clamping range Rd	6-10 mm
Material thickness	2.5 mm
Screw	M10 x 35 mm
Material of screw / nut	StSt
Screw-retaining thread insert	yes
Lightning current carrying capability (10/350 µs)	100 kA / 50 kA *)
Standard	EN 62561-1
Weight	53 g
Customs tariff number (Comb. Nomenclature EU)	85389099
GTIN	4013364032194
PU	1 pc(s)

*) For exact assignment, see test certificate.

We reserve the right to introduce changes in performance, configuration and technology, dimensions, weights and materials in the course of technical progress. The figures are shown without obligation.