



MPE S 35 ER (306 230)

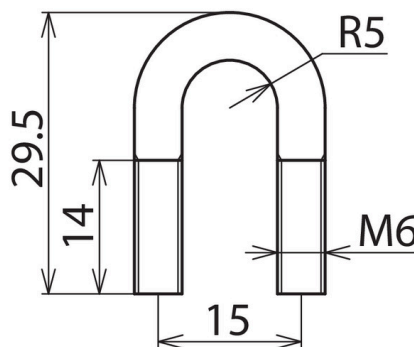

Figure without obligation

Cable clamp (MPE S 35 ER) as strain relief for installing 35 mm² copper cables on the equipotential bonding plate PAP1 EX KB ER or PAP1 EX GI ER.

Type	MPE S 35 ER
Part No.	306 230
Material	StSt
Connection to	PAP1 EX KB ER or PAP1 EX GI ER
Clamping range copper cable	35 mm ²
EX zone	2/22
Weight	11 g
Customs tariff number (Comb. Nomenclature EU)	85389099
GTIN	4013364327443
PU	10 pc(s)

We reserve the right to introduce changes in performance, configuration and technology, dimensions, weights and materials in the course of technical progress. The figures are shown without obligation.