

PCE data sheet

article#	383-10f4v
article description	CEE-flanged socket straight 55x55mm 16A 3p 24/42VDC IP44/IP54 TWIST
description long	CEE-flanged socket straight 55x55mm 16A 3p 24/42VDC IP44/IP54 TWIST housing material: PA6 rated current: 16A number of poles: 3 (3P) clock-position: 10h rated voltage/frequency: 24/42V DC contacts: brass nickel plated connection technology: screw terminals dimensions (flange/fixing center): 55x55 mm / 41x41 mm IP protection class: IP44/IP54
GTIN (EAN)	9003399933509
country of origin	AT
customs number	85366990
net weight	0.132 kg
packaging quantity	10
minimum order quantity	10

ETIM 7.0	EC001317
IEC-amperage	16 A
Voltage acc. EN 60309-2	<50 V DC grey
Number of poles	3
Clock hour position	10 h
Identification colour	White
Degree of protection (IP)	IP54
Connection system	Schraubklemme
Angle of plug	Straight
Material	Plastic
Flange size vertical	55 mm
Drill hole distance vertical	41 mm
Flange size horizontal	55 mm
Drill hole distance horizontal	41 mm

wire flexible	1-10 mm ²
wire solid	1,5-10 mm ²
contact screws	160 Ncm
dismantling length	70 mm
stripping length	14-16 mm

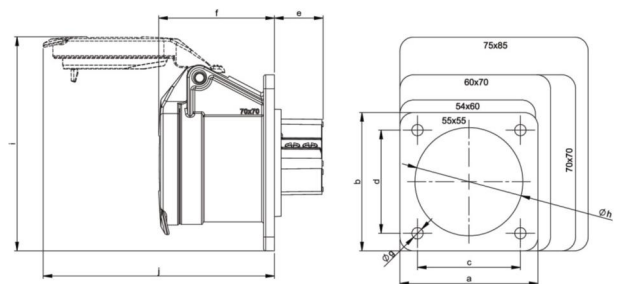

www.manufacturer-safety.info