



Digital Strip Series



Internally Stored Program Breakpoint Resume Addressable RGB Strip

Internally Stored Program Breakpoint Resume Addressable RGB Strip



Product Features

- Adopt top quality and super bright LED, low power, less heat and longer lifespan.
- Low Voltage, High safety.
- Two signals Breakpoint resume to ensure higher stability. Signal can be transported when one chip damaged.
- Compatible with most of pixel controllers
- Without controller, strip will be operating with internally stored program



Structure & Spec.

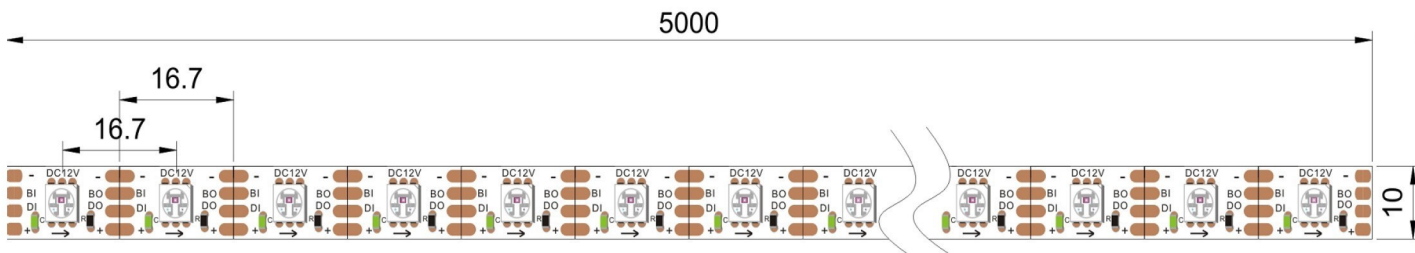

LED Type	Voltage	LED Q,ty/M	Gray Scale	Control Mode
SMD5050 60PCS/M	DC12V	60pcs	256	Internal/External
Watt	Pixel	FPC Width	environment humidity	Working Temperature
Max.14.4W	10pix/M	10mm	40 - 70% RH	-20~50 ℃

Wiring diagram

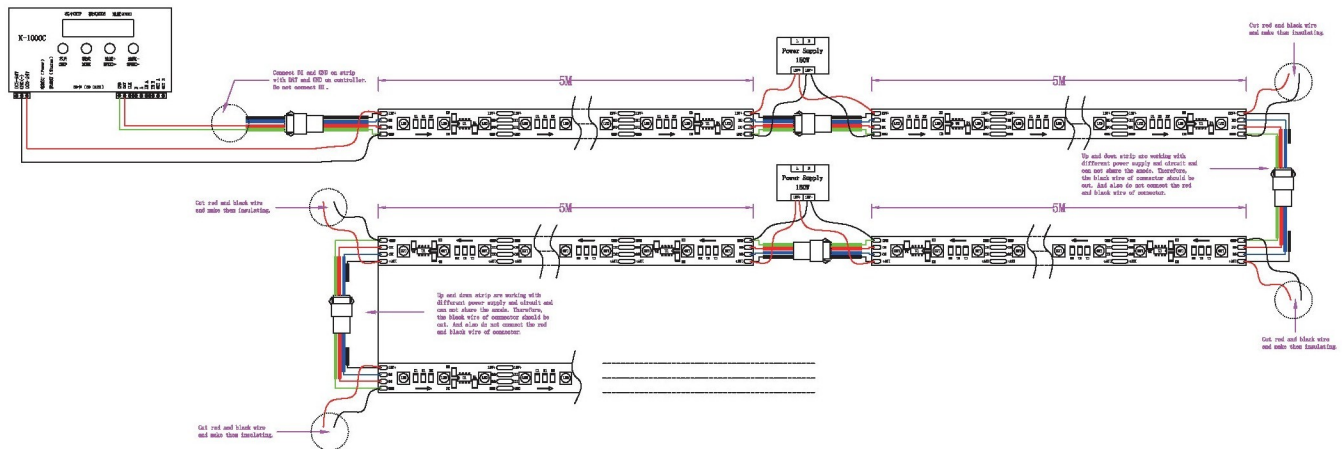

Digitální LED pásek je směrový, nutno zapojit signál z ovladače po směru šipky na pásku, v opačném případě nebude pásek funkční !!!



CAUTIONS

➤ When install the led strip, please note the installation technique. The led strip can be bent, but not distorted, as shown below.

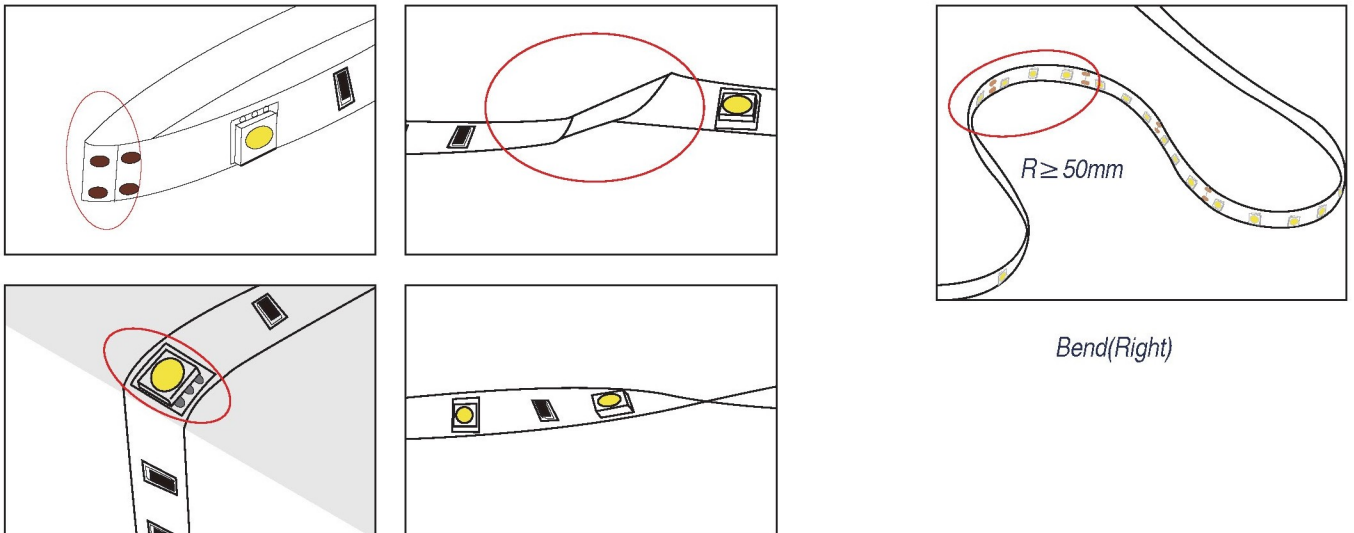

Distortion (Wrong)

Bend (Right)

➤ LED strips are low voltage products, you must use the power supply (transformer). Please don't connect the led strip directly to the AC 110v or AC 220v, otherwise it will burn out the LED strips.

➤ Clean up the installation surface, it will ensure the reliability of the adhesive. The electrical connection process must be operated by a professional person.



Notice:

Without insulating treatment, the LED Strip can not be stacked with power, or LED Strip will be damaged because of short circuit. Power can be only connected when strip is not stacked.