

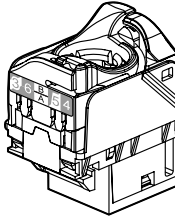

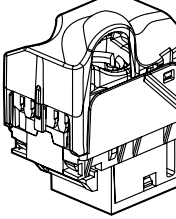

UTP/FTP





Cat 6A UTP

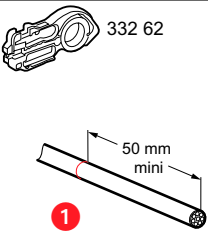
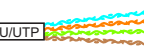
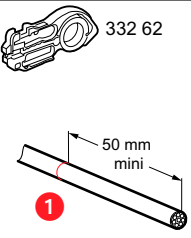
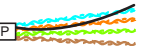
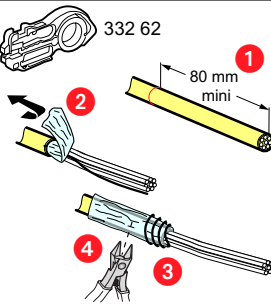
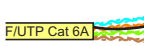
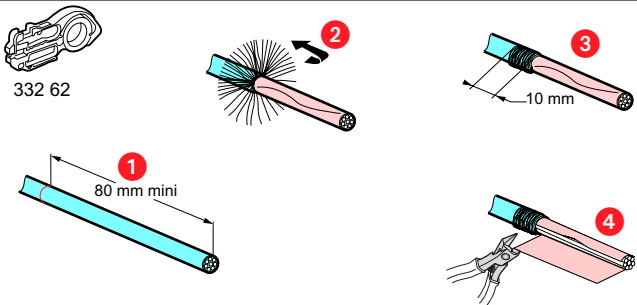

STP

	UTP 	FTP 	STP 
Cat 5e	SK01	SK02	-
Cat 6	SK51	SK52	SK53
Cat 6A	SK61	-	SK63

U/UTP	F/UTP	F/UTP Cat 6A	SF/UTP
 <p>332 62</p> <p>50 mm mini</p> <p>1</p> <p>U/UTP </p>	 <p>332 62</p> <p>50 mm mini</p> <p>1</p> <p>F/UTP </p>	 <p>332 62</p> <p>80 mm mini</p> <p>1</p> <p>2</p> <p>3</p> <p>4</p> <p>F/UTP Cat 6A </p>	 <p>332 62</p> <p>80 mm mini</p> <p>1</p> <p>2</p> <p>3</p> <p>4</p> <p>SF/UTP </p>

**S/FTP**

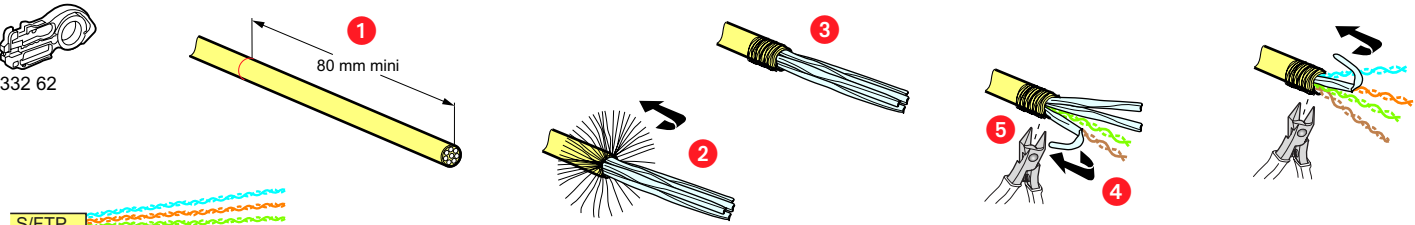

332 62

80 mm mini

1

2

3

4

5

S/FTP 

**F/FTP**

$\varnothing > 9 \text{ mm}$

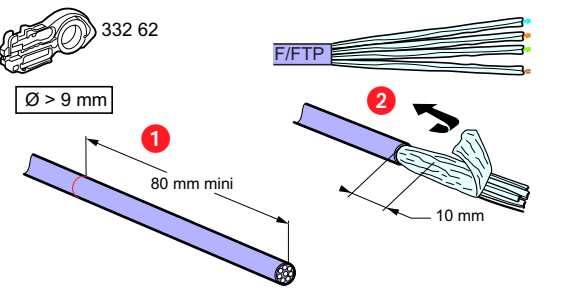

332 62

80 mm mini

1

2

3

4

5

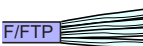
F/FTP 

$\varnothing < 9 \text{ mm}$

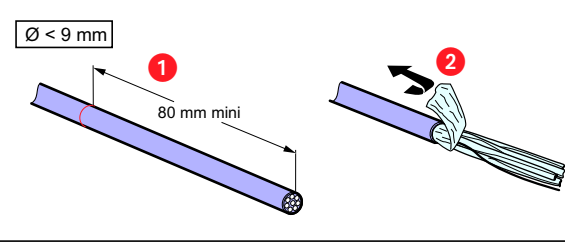

332 62

80 mm mini

1

2

3

4

5

F/FTP 

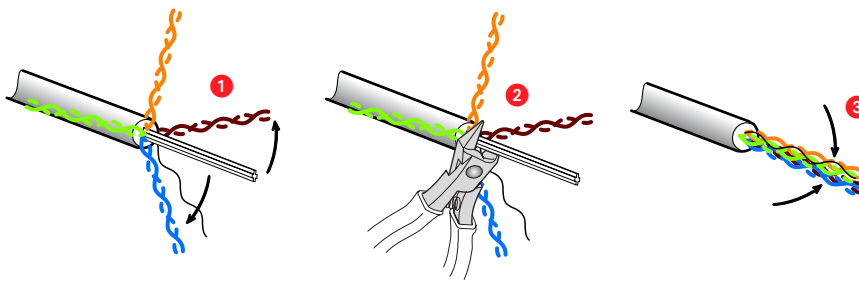

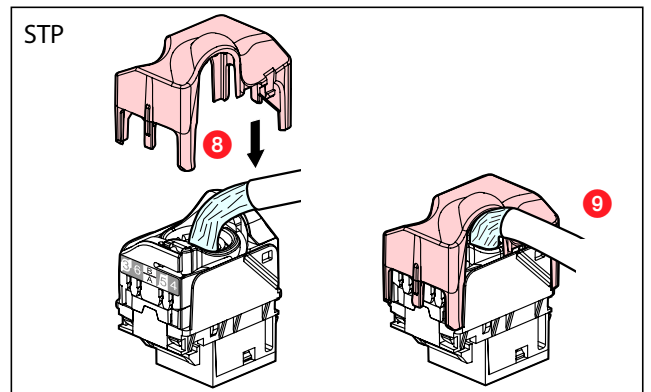
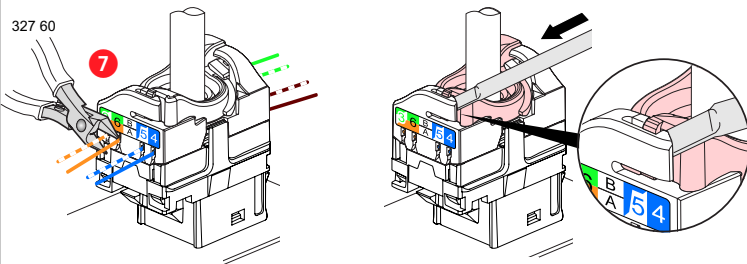
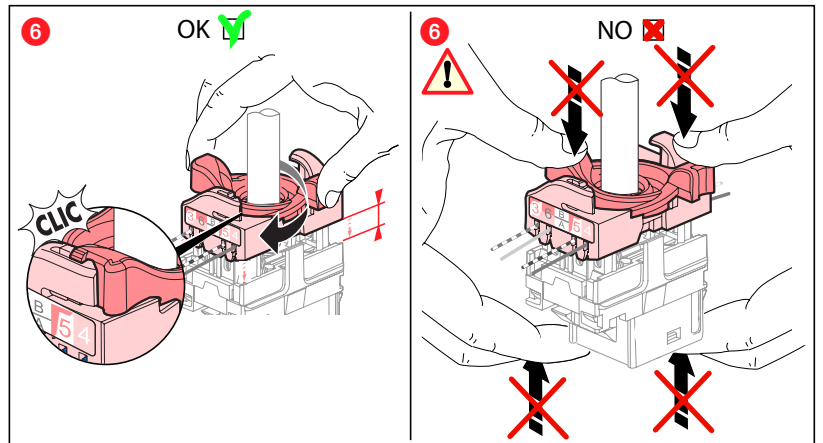
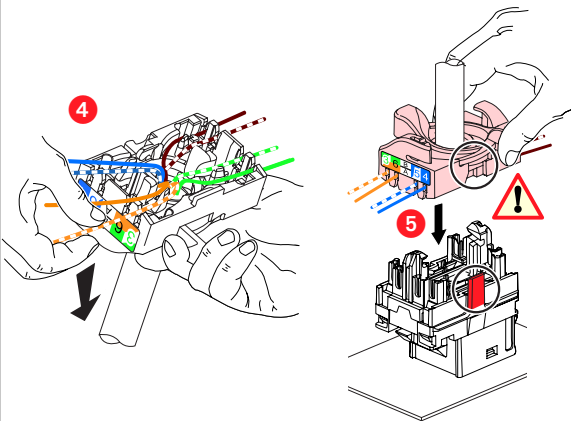
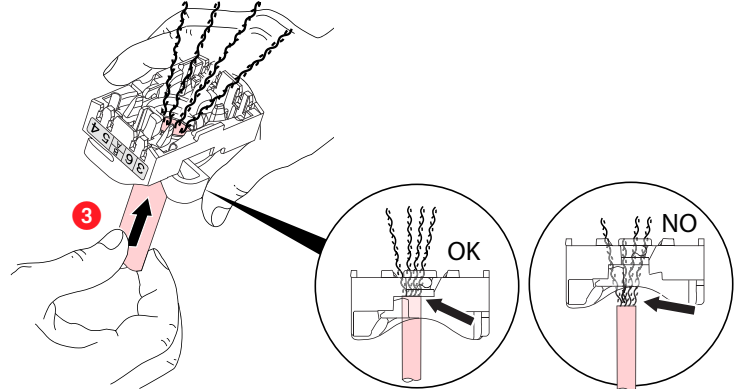
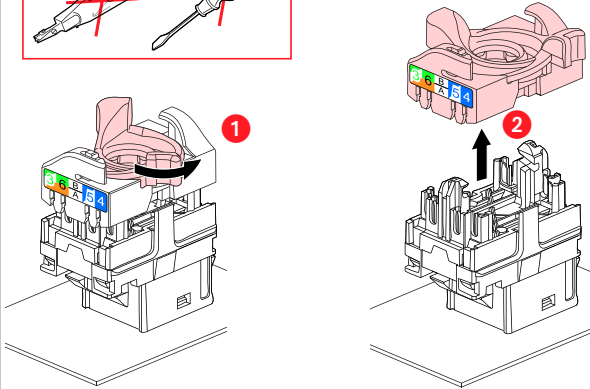
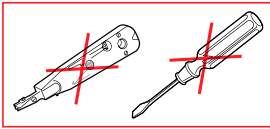
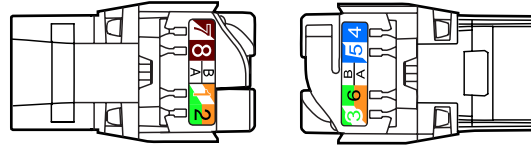
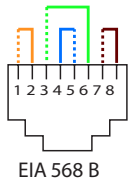
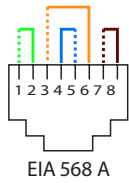

⚠ Consignes de sécurité (FR LU BE CH)  
 Avant toute intervention, couper le courant.  
 Respecter strictement les conditions d'installation et d'utilisation.

⚠ Consignas de seguridad (ES)  
 Antes de realizar cualquier intervención, cortar la corriente eléctrica.  
 Respetar estrictamente las condiciones de instalación y uso.

⚠ Veiligheidsvoorschriften (NL BE)  
 Onderbreek voor enige ingreep de stroom.  
 Neem de installatie- en gebruiksvoorwaarden nauwgezet in acht.

⚠ Instruções de segurança (PT)  
 Antes de qualquer intervenção, desligar a corrente.  
 Respeitar rigorosamente as condições de instalação e de utilização.

⚠ Safety instructions (GB IE)  
 Make sure the power supply is disconnected before any intervention.  
 Strictly comply with instructions for installation and use.

⚠ Συστάσεις ασφαλείας (GR CY)  
 Πριν από οποιαδήποτε επέμβαση, διακόψτε την παροχή ρεύματος.  
 Να τηρείτε ανστηρά τις συνθήκες εγκατάστασης και χρήσης.

⚠ Sicherheitshinweise (DE CH)  
 Vor jeglichem Eingriff die Spannungsfreiheit sicherstellen.  
 Einbau- und Gebrauchsanleitungen sind genau zu beachten.

⚠ Меры предосторожности (RU)  
 Отключить питание перед проведением любых ремонтных работ.  
 Строго соблюдайте требования к условиям монтажа и эксплуатации.