

	100 V~ - 240 V~
	50 / 60 Hz
	2 x 2,5 mm ²
	-5°C / +45°C
	PIR
	300 lux
	15 min.
	2,5 m Ø 6 10 Ø 20

230 V~	2000 W	8,5 A	1000 VA	4,3 A	1000 VA	4,3 A	10x(2x36 W)	4,3 A
110 V~	1000 W		500 VA		500 VA		5x(2x36 W)	

230 V~	250 W	1 A	250 W	1 A	250 W	1 A	500 VA	2,1 A
110 V~	125 W		125 W		125 W		250 VA	

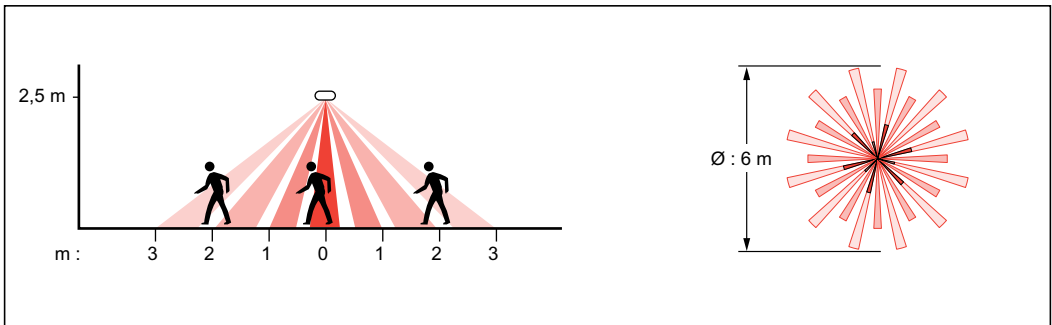

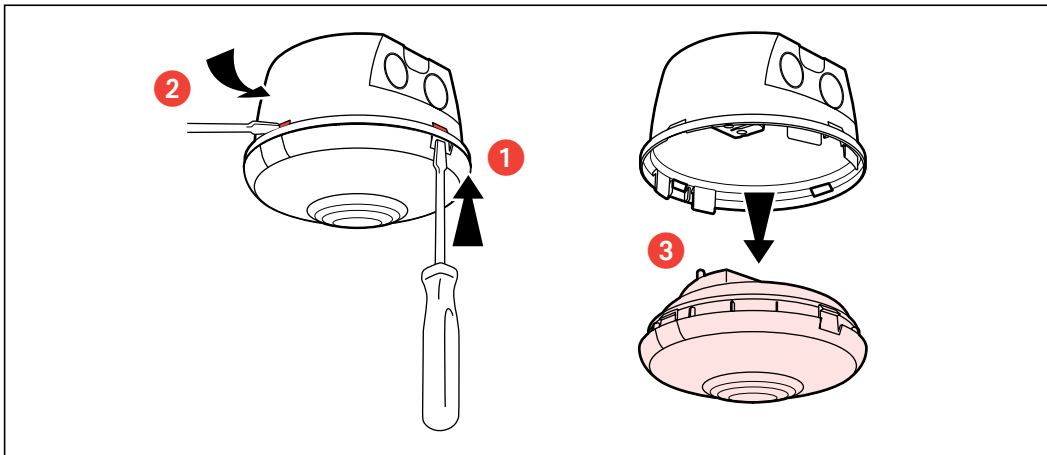
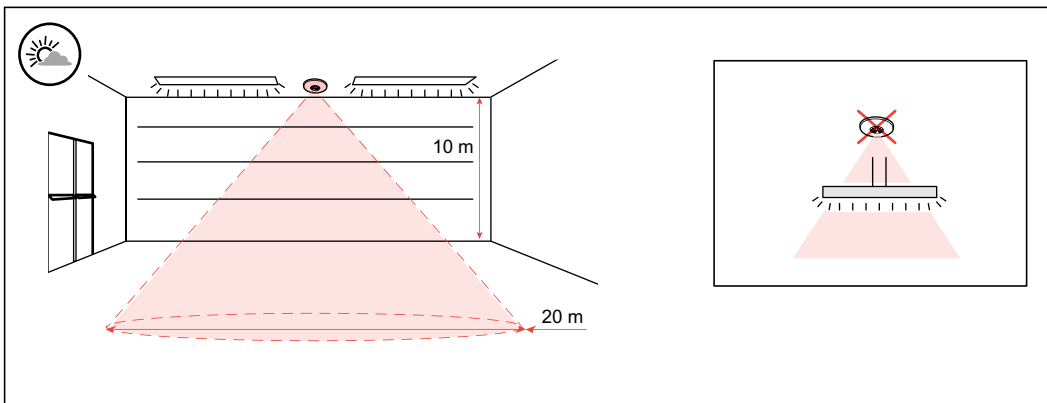
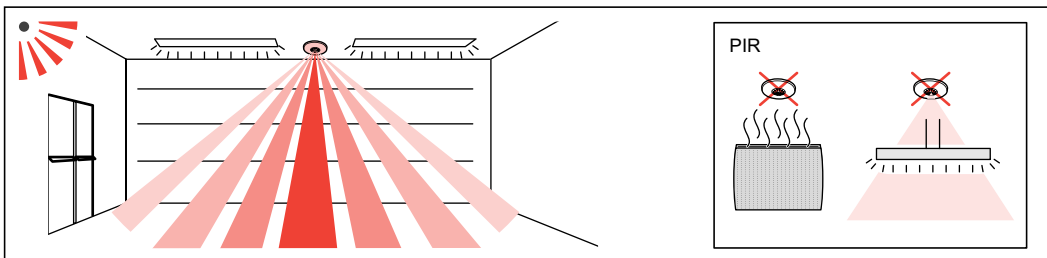
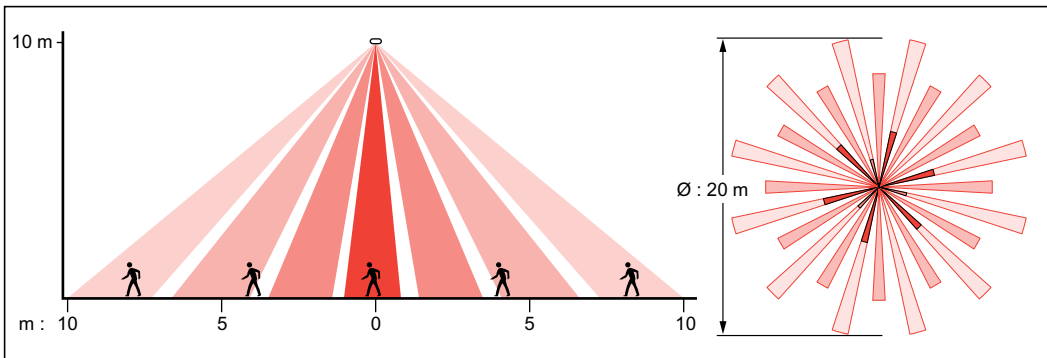

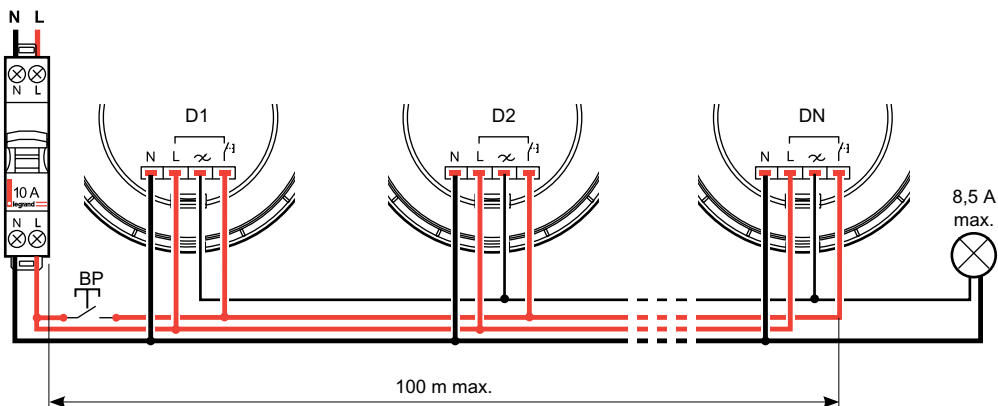
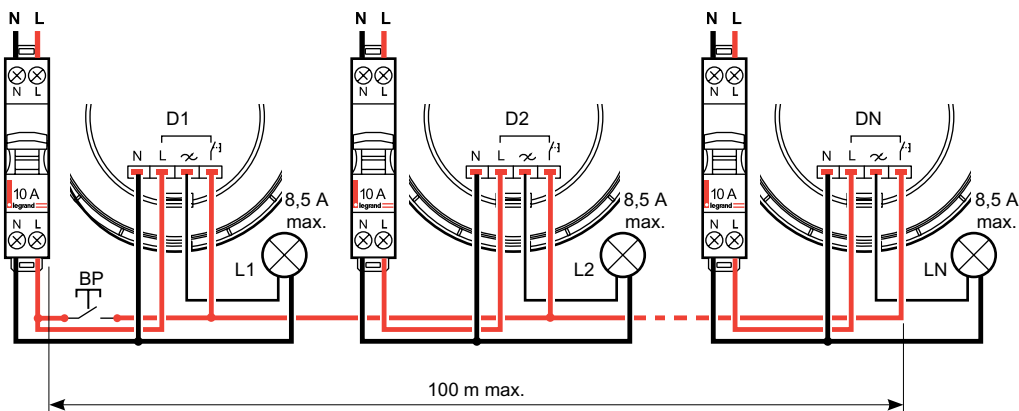
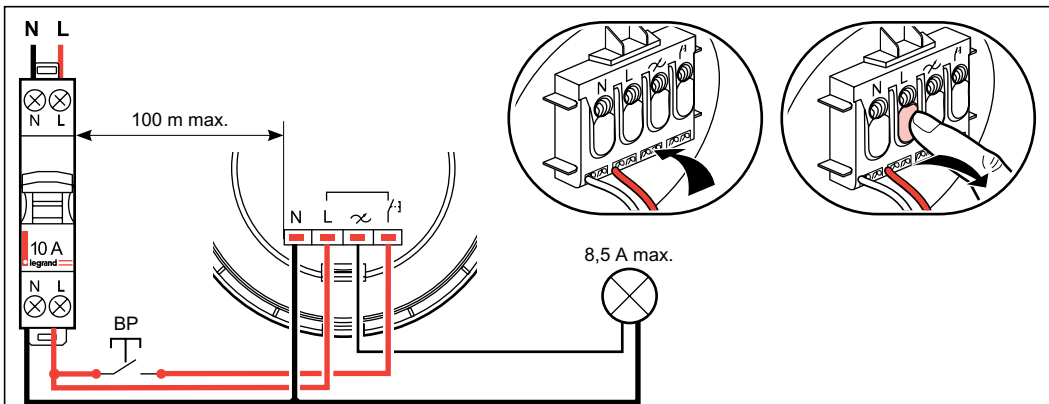



IP 55

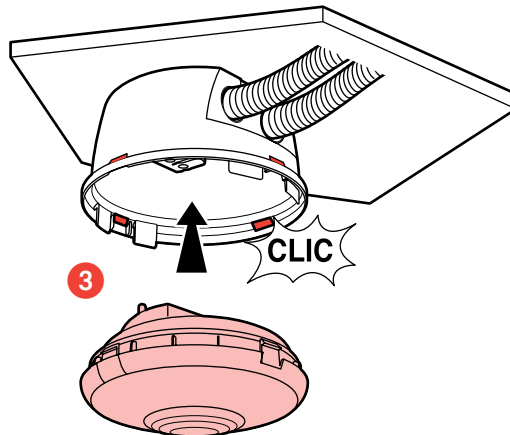
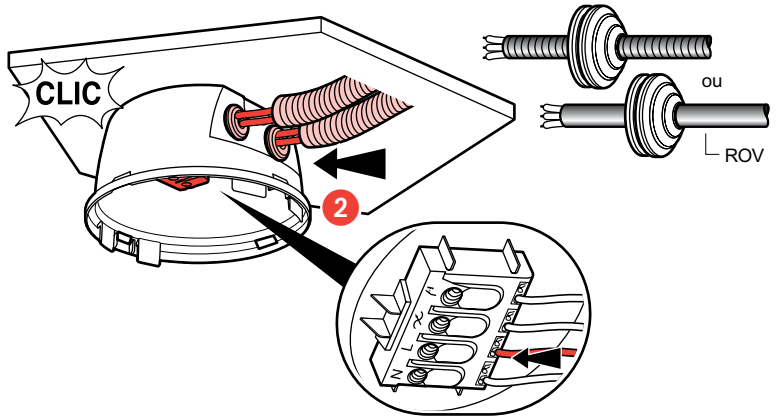
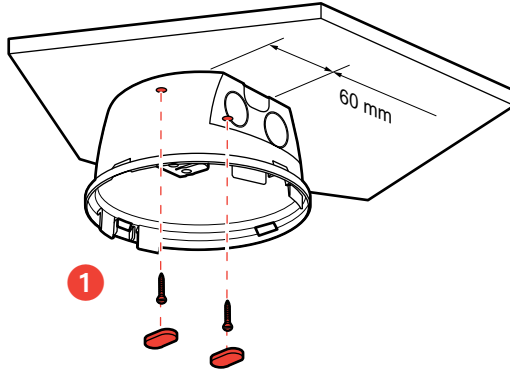

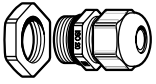

IP 66
Non livré

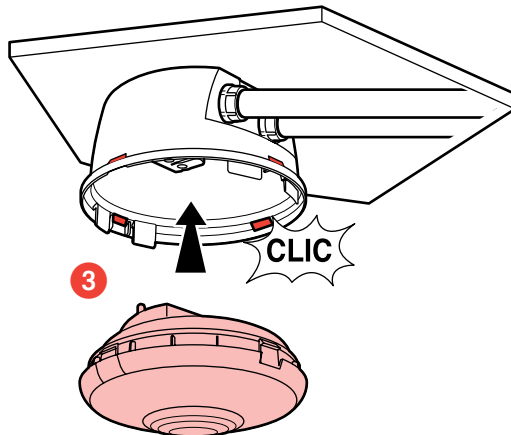
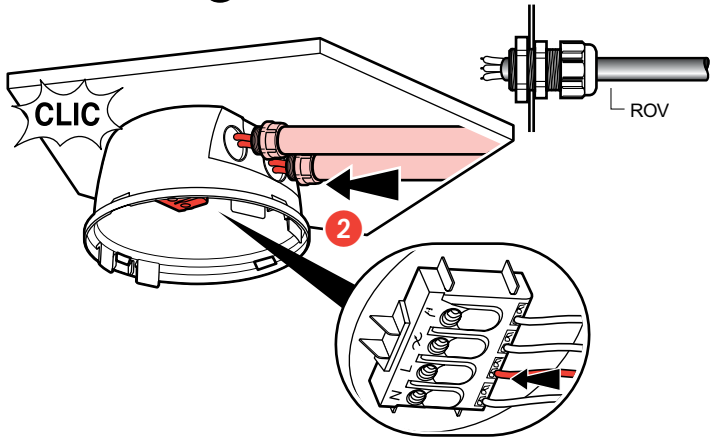
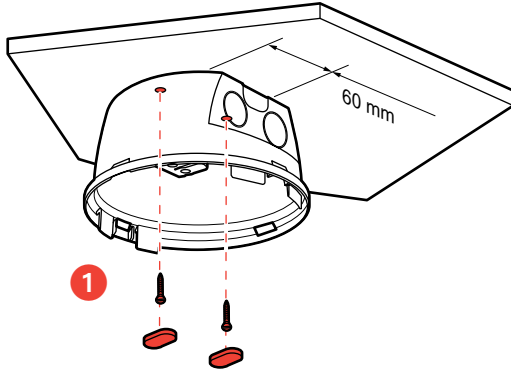



Auto ON/OFF

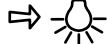
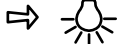
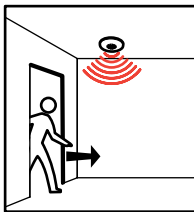

Manual ON / Auto OFF

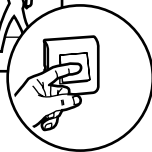
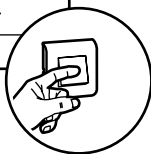
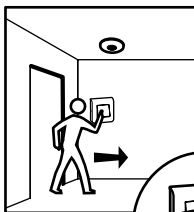

www.legrandoc.com

	5 - 1275 lux
	5 sec - 59 min 59 sec
	25% - 50% - 75% - 100%
Mode	Auto - Manual - Walkthrough

- LED Learn
- Learn LED
- Bouton Learn
- Learn Button

- Détecteur/ capteur PIR
- PIR sensor

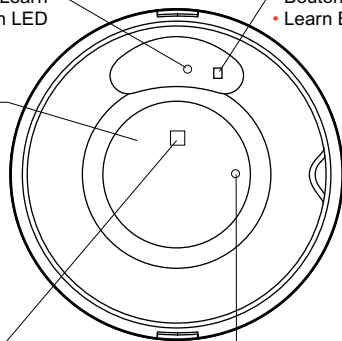

- Cellule de luminosité
- Daylight sensor

- LED de détection
- Motion LED



4 m

+/- 15°



0 882 30



0 882 35